

# High Precision Resistors

High precision, matched pair SIP resistor networks utilizing NiCr thin film spattered on to an alumina substrate using high density patterning technologies. These models exhibit 1ppm 0.05%, tight ratio tolerance and TCR tracking (2T Series). The 2S and 2M models are economical and show good performance. A large variety of quick delivery resistances are available. The 2.5mm width and 5mm height is ideal for high density layouts. Application for 2S(wide) include: Voltage dividers, feed back resistors, voltage reference circuits in data processing, data transmission, precision power sources for industrial controls, medical and measurements.

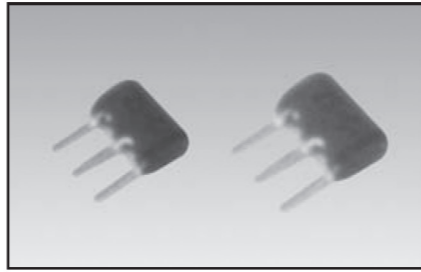

## GENERAL SPECIFICATIONS

Model	Resistance[Ω]		Tolerance(%)		TCR		Pin Configurations
	R1,#2,-#3	R2,#1,-#2	Absolute	Ratio	Absolute	Tracking	
2M-01, 2S-01	1K	1K	±1	0.1	±25ppm	5ppm	
2M-02, 2S-02	1K	10K	±1	0.1	±25ppm	5ppm	
2M-03, 2S-03	10K	10K	±1	0.1	±25ppm	5ppm	
2M-04, 2S-04	10K	20K	±1	0.1	±25ppm	5ppm	
2M-05, 2S-05	20K	20K	±1	0.1	±25ppm	5ppm	
2M-06, 2S-06	15K	15K	±1	0.1	±25ppm	5ppm	
2M-07, 2S-07	30K	30K	±1	0.1	±25ppm	5ppm	
2M-08, 2S-08	3K	680	±1	0.1	±25ppm	5ppm	
2M-09, 2S-09	2.2K	10K	±1	0.1	±25ppm	5ppm	
2M-10, 2S-10	50K	50K	±1	0.1	±25ppm	5ppm	
2M-11, 2S-11	30K	10K	±1	0.1	±25ppm	5ppm	
2M-12, 2S-12	60K	20K	±1	0.1	±25ppm	5ppm	
2M-13, 2S-13	18K	2K	±1	0.1	±25ppm	5ppm	
2M-14, 2S-14	1K	3K	±1	0.1	±25ppm	5ppm	
2M-15, 2S-15	1K	9K	±1	0.1	±25ppm	5ppm	
2M-17, 2S-17	3K	6K	±1	0.1	±25ppm	5ppm	
2M-18, 2S-18	2K	10K	±1	0.1	±25ppm	5ppm	
2T-01	1K	1K	±0.1	0.05	±5ppm	1ppm	
2T-02	1K	10K	±0.1	0.05	±5ppm	1ppm	
2T-03	10K	10K	±0.1	0.05	±5ppm	1ppm	
2T-04	10K	20K	±0.1	0.05	±5ppm	1ppm	
2T-05	20K	20K	±0.1	0.05	±5ppm	1ppm	
2T-06	15K	15K	±0.1	0.05	±5ppm	1ppm	
2T-07	30K	30K	±0.1	0.05	±5ppm	1ppm	
2T-08	3K	680	±0.1	0.05	±5ppm	1ppm	
2T-09	2.2K	10K	±0.1	0.05	±5ppm	1ppm	
2T-10	50K	50K	±0.1	0.05	±5ppm	1ppm	
2T-11	30K	10K	±0.1	0.05	±5ppm	1ppm	
2T-12	60K	20K	±0.1	0.05	±5ppm	1ppm	
2T-13	18K	2K	±0.1	0.05	±5ppm	1ppm	
2T-14	1K	3K	±0.1	0.05	±5ppm	1ppm	
2T-15	1K	9K	±0.1	0.05	±5ppm	1ppm	
2T-17	3K	6K	±0.1	0.05	±5ppm	1ppm	
2T-18	2K	10K	±0.1	0.05	±5ppm	1ppm	

## CHARACTERISTICS

Values in [ ] mean change in Ω after test

	2T	2S	2M	Condition
Rating Power/Element	125 mW	125 mW	125 mW	250mW / Package
Rated Ambient Temp.	70°C	70°C	70°C	
Operating Temp. Range	-55°C~125°C			
Insulation Resistance	10,000[MΩ]			
Dielectric Withstanding Voltage	±[0.1%+0.01Ω] 1000VAC, 60sec.			
Maximum Applied Voltage	[100V] Accordance with E=√P.R			
Short Time Overload	±[0.1%+0.01Ω] 2.5 times rated power, 5sec.			
Moisture Resistance	±[0.25%+0.01Ω] 60°C, 90-95RH, DC 0.1W, 1,000hours			
Soldering Heat	±[0.1%+0.01Ω] 350°C, 3sec.			
Load Life	±[0.1%+0.01Ω] 70°C, 90minutes on, 30minutes off, 1000hours			

## DIMENSIONS (mm)

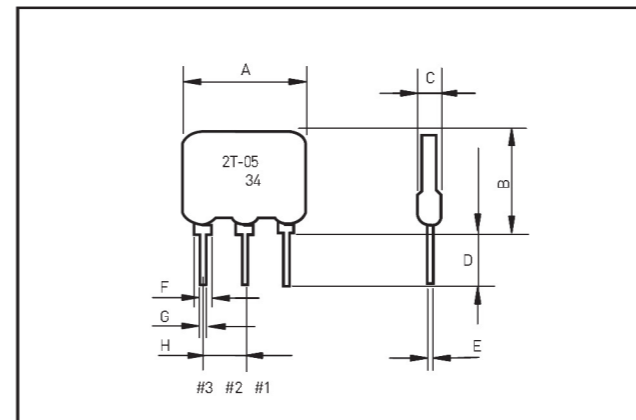

	2T	2S	2M
A	8.0max	8.0max	8.0max
B	5.0max	5.0max	7.0max
C	2.54max	2.54max	2.54max
D	3.3	3.3	3.3
E	0.25	0.25	0.25
F	1.2	1.2	1.2
G	0.5	0.5	0.5
H	2.54	2.54	2.54

## ORDERING PROCEDURE EXAMPLE

